

ChiFun K Workshop Store
98.6% Positive feedback

+ Follow
1792 Followers

I'm shopping for... 0

On AliExpress In this store

Store Home | Products | Sale Items | Top Selling | PLC | Industrial controller | Feedback

0-20MA/4-20MA/0-5V/0-10V 4AO analog output adjustment module RS485 M ODBUS

US \$45.85

US \$2.00 New User Coupon [Get coupons](#)

Quantity:

- 1 + 4% off (5 pieces or more)
998 pieces available

Shipping: US \$2.46

to United States via AliExpress Standard Shipping
Estimated Delivery on Jul 01

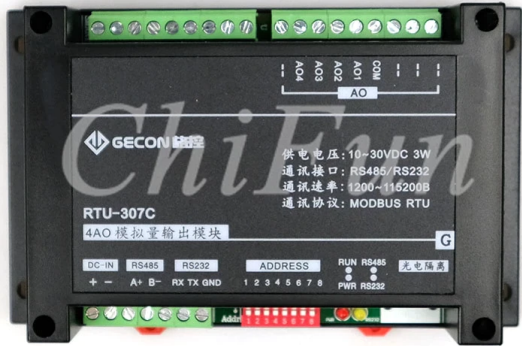

Buy Now

Add to Cart

3

75-Day Buyer Protection
Money back guarantee



Store Categories

Motor & motor parts

- motor drive
- Stepper motor
- Motor & Drive kit
- Spindle motor
- PWM controller
- Synchronous motor
- CNC Accessories
- Micromachine

PLC

- PLC cable
- PLC board
- Motor controller
- HMI
- Kinco PLC
- Compatible with Siemens PLC

CNC accessories

- accessories
- Frequency converter
- MACH3 motion control card
- Micro sawing machine
- Switching power supply

Industrial controller

ChiFun K Workshop...

98.6% Positive Feedback
1792 Followers

Contact

+ Follow

Visit Store



US \$33.12



US \$37.66



US \$24.95



US \$29.96



US \$35.18



US \$31

OVERVIEW

CUSTOMER REVIEWS (0)

SPECIFICATIONS



高性能 MODBUS-I/O 模块				
型号	AO	RS232	RS485	MODBUS-RTU 协议
RTU-307C	4	1	1	支持

- acquisition module
- Converter
- Spectrum Analyzers
- Signal generator
- Oscilloscope
- Multimeters
- Oscilloscope Probe & Accessories
- Network relay
- Tester
- ▶ **Audio amplifier & radio**
 - electronic tube
 - Electron tube parts
 - Tecsun radio
- ▶ **Electronic Components & Supplies**
 - LED Lights
 - Electronic Components
 - Tempareture switch
 - Electronic module
 - Water level sensor
 - MPPT
 - Knob
- ▶ **Micro machine**
 - Velometer
- ▶ **DIY Parts of machine**
 - Audio transformer
 - Contactor
 - Capacitance
 - Fuses
 - Relay
 - Mini Motor
 - Audio isolator
- ▶ **Others**

供电电压: 24VDC 12VDC
 通讯接口: RS485 RS232
 通讯协议: MODBUS RTU/ASC

高性能MODBUS控制器

电源	RS485	RS232	ADDRESS	RUN RS485
+ -	A+ B-	RX TX GND	1 2 3 4 5 6 7 8	● ● PWR RS232

Note !

- Please read this manual carefully before operation!
- Please disconnect the input power before installing the wiring!
- Make sure the wiring is correct before turning on the power!
- Do not operate in flammable or explosive environments!
- Please operate within the specified voltage range!

Module Overview

Our general-purpose data acquisition module developed for various applications is widely used in buildings, HVAC, fire protection, water supply, petrochemical, and environmental protection industries. It is used by most system integrators and automation companies and research institutes. With a very high character ratio, stable and reliable data acquisition module.

- => Supports configuration software such as Kingview, force control, MCGS and so on.
- => Support RS232, RS485 interface, Modbus protocol touch screen, text screen;
- => Supports all standard Modbus device online communication;

Top Selling



US \$119.95

★ 5.0 71 Sold

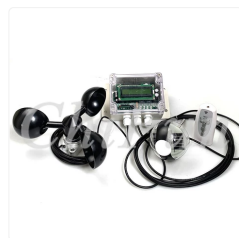

US \$73.96

★ 4.9 59 Sold



US \$67.95

★ 4.6

22 Sold



US \$67.95

★ 4.8

20 Sold

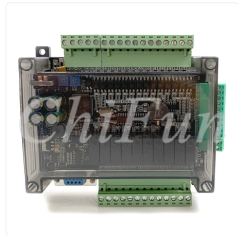

US \$38.99

★ 5.0

21 Sold

[View More >](#)

CPU	32-bit ATMEL ARM high-speed processor, 72MHZ
Operating system	GCOS, 10ms scheduling mechanism
Supply voltage	7-35VDC @2W, Reverse power protection, isolated design
Communication Interface	DC isolation design, 2500V lightning protection, ESD, overvoltage, overcurrent protection
Dimensions	Volume (length x width x height): 180x108x44 (mm)
Installation method	Screw or rail mounting
	
Environmental indicators	-40~85℃, 5%~95%RH Non condensation, IP20 protection
Hardware watchdog	1.5S hardware watchdog protection system
Channel isolation	2500VDC isolation, anti-jamming protection design



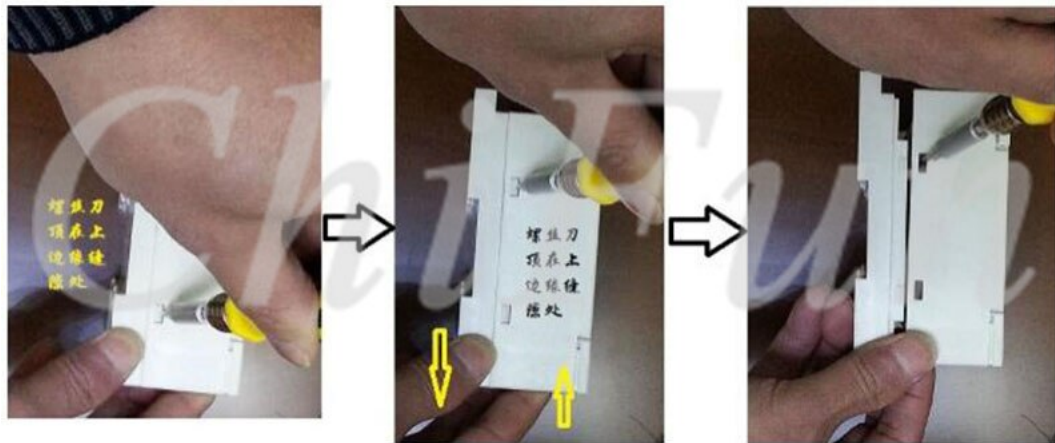

RS485/RS232

Channels Number	1 way RS485	1 way RS232
Baud rate	1200~115200, Default 9600	
Parity check	Odd test, even check, non check	
Start bit	1 bit	
Data bit	8 bit	
Stop bit	1、2 bit	
Communication protocol	MODBUS RTU	
Default parameters	9600.N.8.1. station number is: 1	

UART0-RS485		UART1-RS232	
地址:	1	地址:	1
波特率:	9600	波特率:	9600
校验:	NONE	校验:	NONE
数据位:	8	数据位:	8
停止位:	1	停止位:	1
模块类型:	I/O 模块	模块类型:	I/O 模块
协议类型:	MODBUS_RTU	协议类型:	MODBUS_RTU
应答超时:	100 10ms	应答超时:	100 10ms

UART0/1
Configuration
instructions

- Address: Two configuration methods
It can be configured by software or configured by dial switch;
See the section: "Module Address"

type;

- Type of protocol:

Standard MODBUS RTU protocol;

Other options: Keep unused;

RS485接线图

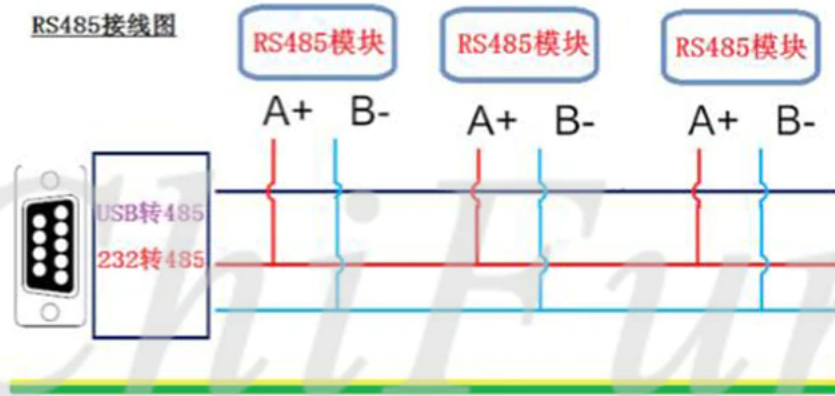

RS232接线示意图

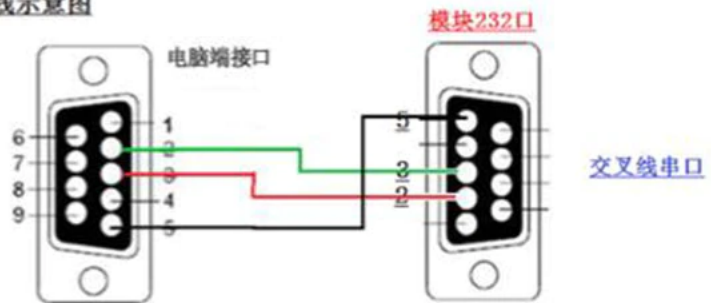

Modbus address	40001~40004, Function code: 16 <Hex: 10H>	
Output type	Current: 4~20mA/0~20mA	Voltage: 0~5V/1~5V/0~10V
Output configuration	<p>Factory default: 4 ~ 20mA / 0 ~ 20mA adaptive output;</p> <p>Configuration steps:</p> <ol style="list-style-type: none"> 1. Module open cover, each way has a jumper cap, can be pulled out; 2. Jumper cap closed: 1 ~ 5V / 0 ~ 5V / 0 ~ 10V adaptive output 3. Jumper cap is broken: 4 ~ 20mA / 0 ~ 20mA adaptive output 	
Output accuracy	0.2% accuracy, 12 bits	
Load Resistance	<p>Current output: load $R \leq 750\Omega$</p> <p>Voltage output: load $R \geq 2K\Omega$</p>	
Data range	<p>4~20mA Corresponding: 10000~50000 <Unsigned 16-bit integer></p> <p>0~20mA Corresponding: 00000~50000</p> <p>1~5V Corresponding: 10000~25000</p> <p>0~5V Corresponding: 00000~25000</p> <p>0~10V Corresponding: 00000~50000</p>	
Calculation formula	<p>4~20mA : Output value * (50000 / 20)</p> <p>0~20mA : Output value * (50000 / 20)</p> <p>1~5V : Output value * (50000 / 10)</p> <p>0~5V : Output value * (50000 / 10)</p> <p>0~10V : Output value * (50000 / 10)</p>	

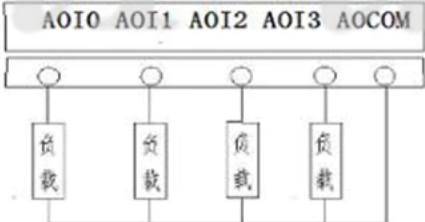
	<p>Register output value = $6\text{mA} * (50000/20) = 15000$</p>
Isolation scheme	2500V, high-speed optocoupler signal isolation
Output connection	<p>模拟量输出接线</p>  <p>The diagram shows a terminal block with five terminals labeled AO10, AO11, AO12, AO13, and AOCOM. Each of the four output terminals (AO10, AO11, AO12, AO13) is connected to a vertical line that leads to a box labeled '负载' (Load). The AOCOM terminal is connected to a common ground line that also connects to the bottom of the load boxes for AO10, AO11, and AO12.</p>

Links

Related Search

modbus digital analog input output
input rs485
modbus output
m7 mp3

max3232
analog input rs485
wago digital input module
analog to modbus

relay usb digital input
dso138
control knob usb
oscilloscop

Hot Search

belt 970699

blank house

bob boy sun

This product belongs to **Home** , and you can find similar products at **All Categories , Tools , Measurement & Analysis Instruments , Measuring Instruments , Oscilloscope Parts & Accessories .**

Help

Customer Service, Disputes & Reports, Buyer Protection, Report IPR infringement

AliExpress Multi-Language Sites

Russian, Portuguese, Spanish, French, German, Italian, Dutch, Turkish, Japanese, Korean, Thai, Vietnamese, Arabic, Hebrew, Polish

Browse by Category

All Popular, Product, Promotion, Low Price, Great Value, Reviews, Blog, Seller Portal, BLACK FRIDAY, AliExpress Assistant

Alibaba Group

Alibaba Group Website, AliExpress, Alimama, Alipay, Fliggy, Alibaba Cloud, Alibaba International, AliTelecom, DingTalk, Juhuasuan, Taobao Marketplace, Tmall, Xiami, AliOS, 1688

[Google Play](#)[App Store](#)